

版次	变更内容	审核	日期

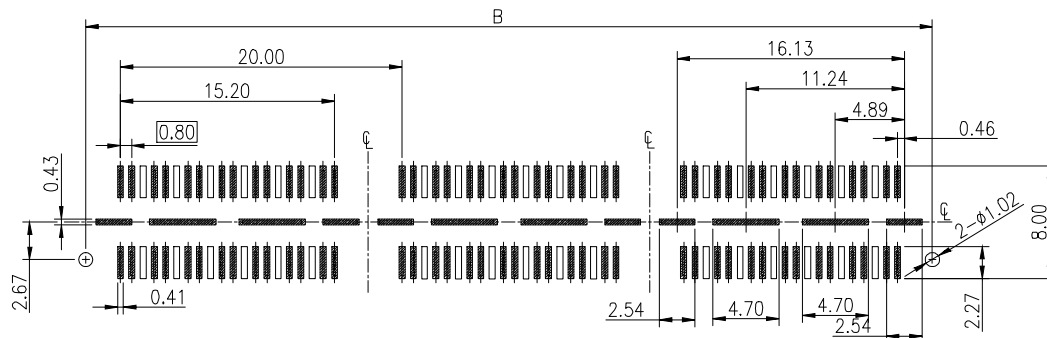
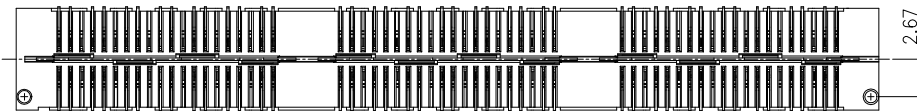
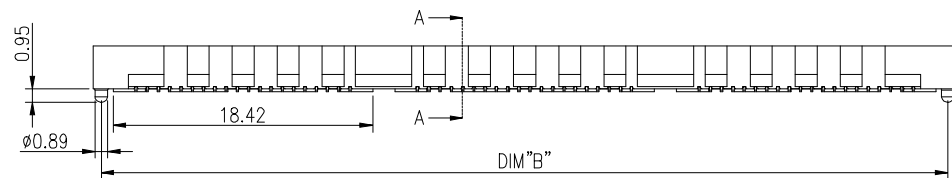
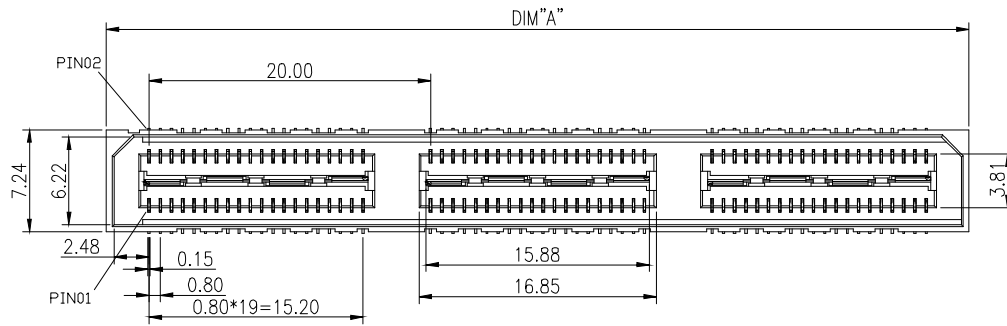

RECOMMEND PCB LAYOUT
TOLERANCE: ±0.05

产品特性:

1. 绝缘体: LCP, UL 94V-0, 颜色: 黑色
2. 端子: 磷青铜
3. 电镀: 接触区镀金
4. 额定电流: 2 A (2个引脚供电)
5. 工作温度: -55° C TO +125° C
6. 额定电压: 225V AC

QSE08-SM-2*xxP X-DP

单排芯数:

接触电镀:

- 5G: 镀金 5u"
- 10G: 镀金 10u"
- 30G: 镀金 30u"

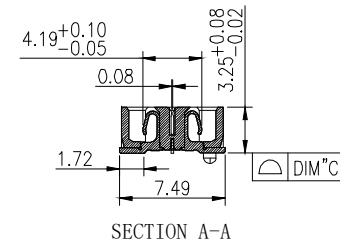

NO. OF contacts	Dimensions		
	A	B	C
2*14	21.28	20.13	0.10
2*28	41.28	40.13	0.10
2*42	61.28	60.13	0.15
2*56	81.28	80.13	0.15
2*70	101.28	100.13	0.15

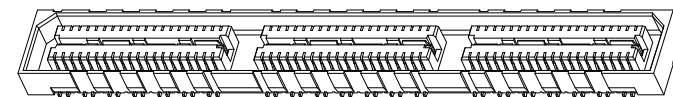

公差:	版次:	A	上海宗进电子科技有限公司 Shanghai Zong Jin Electron Technology Co.LTD		
. X ±0.35	比例:		型号: QSE08-SM-2*xxPX-DP	签名	日期
. XX ±0.25	单位:	mm	描述: 0.5mm BTB 高速接地插座	绘图:	
. XXX ±2°	页码:	1/1	图号:	确认:	
LNLB				审核:	