

版次	变更内容	审核	日期

9, 15, 25&37 Positions

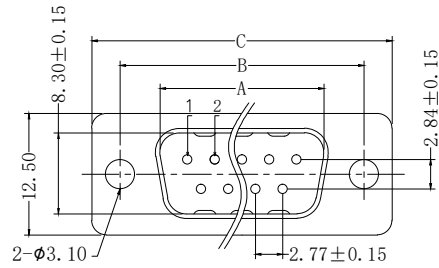

材料(MATERIALS):

端子(Contacts): 黄铜( Brass)  
 端子电镀(Contact plating): 详见料号说明(See number description)  
 绝缘体(Insulator): PBT+G.F, UL94V-0  
 外壳(Shell): 不锈钢(Stainless steel)  
 电气说明(ELECTRICAL SPECIFICATION):  
 额定电流(Current Rating): 5 Amperes  
 额定电压(Dielectric Withstanding Voltage): AC 1000/60ses. r. m. s.  
 绝缘电阻(Insulation Resistance): 1000 MΩ Min. at DC 500V  
 接触电阻(Contact Resistance): 25 mΩ Max.  
 使用温度(Operating Temperature): -40°C~+105°C

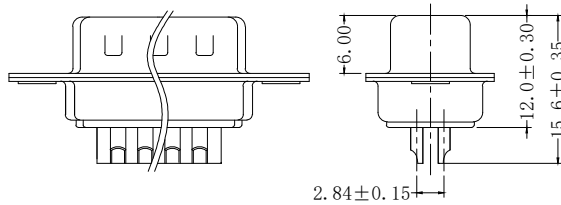
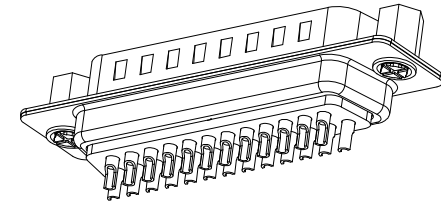

NUMBER OF CONTACTS	A	B	C
	±0.25	±0.25	±0.35
9	16.90	25.00	30.80
15	25.25	33.30	39.20
25	39.00	47.05	53.05
37	55.40	63.50	69.40

H
4.00
5.80

50 Positions

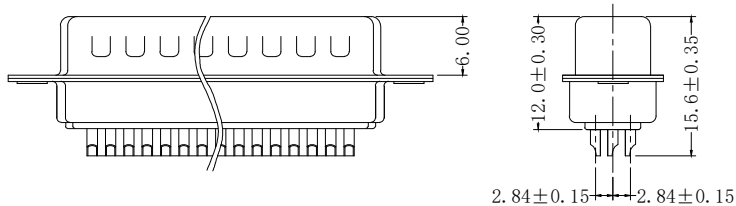
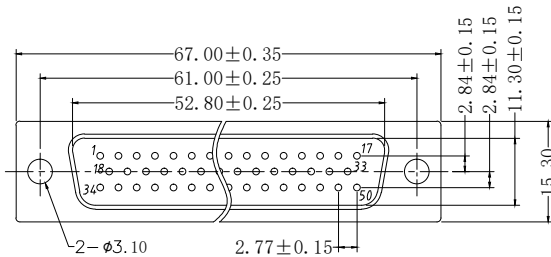

DB-xx M G-A A-1 (CP)-B

芯数: 09, 15, 25, 37, 50  
 极性: F: 公(针)  
 接触电镀: G: 镀金1u", 3G: 镀金3u"  
 螺柱长度: A: 光孔, C: 前: 4.8mm/后: 4.0mm, D: 5.8mm  
 外壳材质: B: 不锈钢  
 车针  
 塑胶颜色: 1: 白色, 2: 蓝色, 3: 黑色  
 螺柱位置: A: 无, B: 前固定, E: 后固定

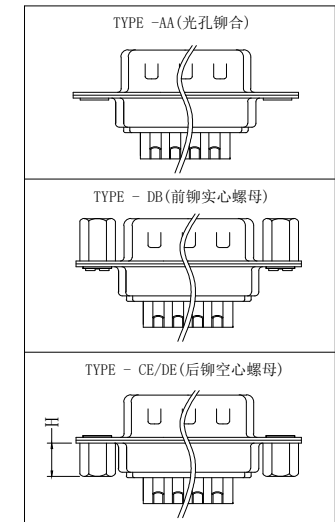

公差:	版次:	A	上海宗进电子科技有限公司 Shanghai Zong Jin Electron Technology Co.LTD		
. X ±0.35	比例:		型号: DB-xxMX-XX-X (CP)-B	绘图:	签名
. XX ±0.25	单位:	mm	描述: D型连接器	确认:	日期
. XXX ±2°	页码:	1/1	图号:	审核:	
LNLB					