

| | | | |
|----|------|----|----|
| 版次 | 变更内容 | 审核 | 日期 |
| | | | |

15, 26, 44, 62 Positions

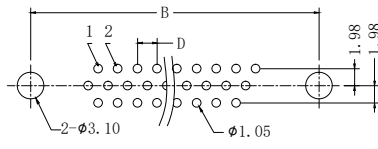

P. C BOARD LAYOUT (26~62PIN)
GENERAL TOLERANCE: ±0.05

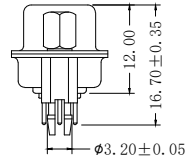
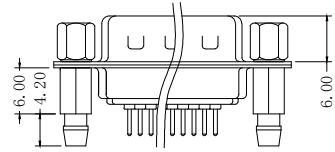
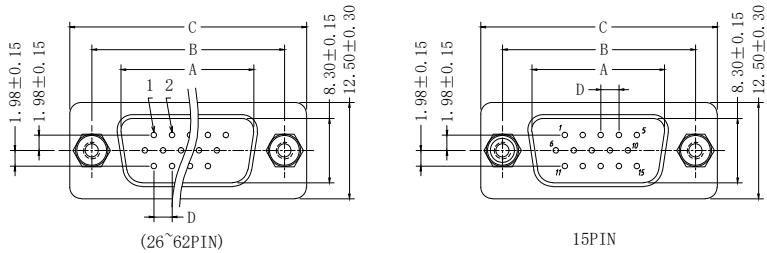
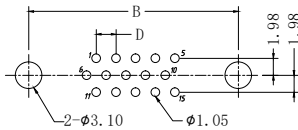

P. C BOARD LAYOUT (15PIN)
GENERAL TOLERANCE: ±0.05

78 Positions

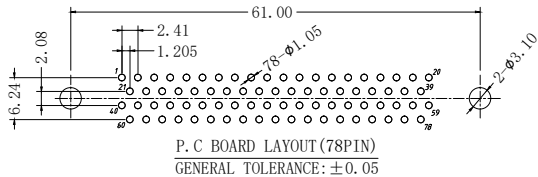
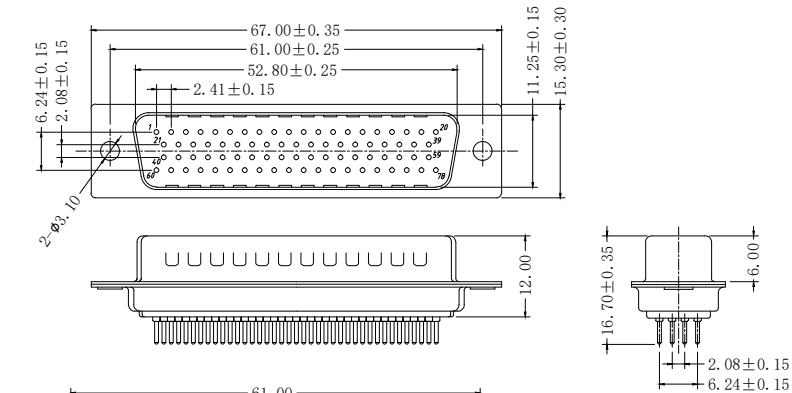

P. C BOARD LAYOUT (78PIN)
GENERAL TOLERANCE: ±0.05

材料 (MATERIALS):

- 端子 (Contacts): 黄铜 (Brass)
- 端子电镀 (Contact plating): 详见料号说明 (See number description)
- 绝缘体 (Insulator): PBT+G.F, UL94V-0
- 外壳 (Shell): 铁材 或 不锈钢 (Steel or Stainless steel)

电气说明 (ELECTRICAL SPECIFICATION):

- 额定电流 (Current Rating): 3 Amperes
- 额定电压 (Dielectric Withstanding Voltage): AC 1000/60ses. r. m. s.
- 绝缘电阻 (Insulation Resistance): 1000 MΩ Min. at DC 500V
- 接触电阻 (Contact Resistance): 25 mΩ Max.
- 使用温度 (Operating Temperature): -40°C~+105°C

| NUMBER OF CONTACTS | A | B | C | D |
|--------------------|-------|-------|-------|-------|
| | ±0.25 | ±0.25 | ±0.35 | ±0.15 |
| 15 | 16.90 | 25.00 | 30.80 | 2.29 |
| 26 | 25.25 | 33.30 | 39.20 | 2.29 |
| 44 | 39.00 | 47.05 | 53.05 | 2.29 |
| 62 | 55.40 | 63.50 | 69.40 | 2.41 |

| H |
|------|
| 4.00 |
| 5.80 |

DMSH-xx M G-A A-1 (CP) -B

芯数
15, 26, 44, 62, 78

极性
M: 公 (针)

电镀规格
G: 全镀金 Gold Flash
3G: 全镀金 3u"
.....

螺柱长度
A: 光孔
C: 前: 4.8mm/后: 4.0mm
D: 5.8mm

外壳材质
B: 不锈钢
缺省: 铁

车针

塑胶颜色
1: 白色
2: 蓝色
3: 黑色

螺柱位置
A: 无
B: 前固定
E: 后固定

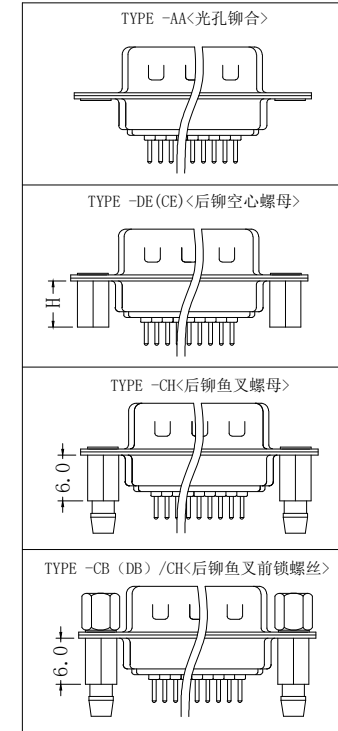

| | | | | | |
|---|-----|-----|--|-----|----|
| 公差: · X ±0.35 · XX ±0.25 · XXX ±2° LNLB | 版次: | A | 上海宗进电子科技有限公司 Shanghai Zong Jin Electron Technology Co.LTD | | |
| | 比例: | | 型号: DMSH-xxMX-XX-X (CP) -X | 签名 | 日期 |
| | 单位: | mm | 描述: D型连接器 | 绘图: | |
| | 页码: | 1/1 | 图号: | 确认: | |
| | | | | 审核: | |